

Abercrombie & Kent



PANACHE RIVER CRUISE

Cruise Alsace & Lorraine onboard the Panache

Cruises, European Canal Barge Cruises



Europe, France



7 days from AU\$10,424 pp



Private

Journey Overview

Panache is a hotel barge that has been fitted out in traditional yacht style with brass and mahogany fittings in the spacious public areas and very comfortable cabin accommodation. In the saloon the panoramic windows let in plenty of natural light, and the tempting cocktail bar and comfortable leather sofas are enhanced by polished hardwood flooring. The separate roomy dining area provides a congenial setting for up to 12 guests to enjoy the gourmet meals and fine wines served on board.

The cabin accommodation comprises six generously-sized junior suites which can be in twin or double-bedded configuration. All the en suite bathrooms have twin hand-basins and oversized showers.

Outside, the spacious sun deck is the perfect place to unwind and admire the passing scenery in one of the comfortable chairs, or to enjoy being served a long, lazy alfresco lunch at the outside dining table. The heated spa pool and plentiful number of bicycles for you to explore the towpath complete the picture.

Panache cruises in Holland in the Spring, when the flowers are in full bloom. This is without a doubt the best time to visit this country, and our cruises in Holland are carefully planned to allow you to experience all that the country has to offer.

She then cruising in Champagne for a number of weeks in May & June. The Champagne itineraries typically include Brie cheese tastings, a tour of the Cathedral at Reims, Epernay and of course, tastings at renowned Champagne houses.

In the Summer and Autumn, Panache cruises the beautiful and varied waterways of Alsace & Lorraine, a region of France offering a unique mix of French and German cultures, history and local gastronomy.

Panache's voyage through Alsace & Lorraine will give you the opportunity to appreciate the very best of the region, passing storybook villages along the way, visiting places such as Strasbourg, renowned for their Baroque and Romanesque architecture and uniquely, experiencing Europe's most famous boat elevator!

Cruise Highlights

Alsace & Lorraine *(July to October)*

- Tour the beautiful city of Strasbourg and visit its Gothic cathedral
- Explore the Route des Vins d'Alsace and a private wine tasting
- Visit the Meteor Brewery, founded in 1640
- Experience an ascent or descent of the unique Arzviller boat elevator
- Visit the spectacular René Lalique Collection
- Tour of Sarrebourg including a visit to the Chagall chapel
- Enjoy a candlelit meal whilst cruising through the two Arzviller tunnels
- Excellent towpath for walking



Itinerary

Day 1: Krafft

Guests are met in Strasbourg** and transferred by private chauffeured minibus to Panache for a Champagne welcome and the first opportunity to meet your crew. Perhaps there is time for a walk or cycle ride before dinner on board.

Panache / Meals: D

Day 2: Krafft to Strasbourg

Our day starts with a morning cruise, across the Gran Ried wetlands and home to an abundance of birdlife, to arrive at the historic city of Strasbourg. Later, we enjoy a tour of the beautiful 'capital city of Europe' including, of course, a visit to the 12th century Gothic pink sandstone cathedral, home to an astronomical Renaissance clock and soaring spire. We visit Place Gutenberg and explore La Petite France, a pedestrian area brimming with half-timbered houses, boutique shops and cafés. Dinner on board.

Panache / Meals: BLD

Day 3: Strasbourg to Waltenheim-sur-Zorn

After breakfast, our cruise takes us past the impressive European Parliament building on the outskirts of Strasbourg and on through the Brumath Forest to our picturesque mooring at Waltenheim-sur-Zorn. This afternoon we enjoy a scenic drive into the rolling Vosges hills on the Route des Grands Vins, where the finest wines of Alsace are produced, and a private tasting of Gewürztraminer, Pinot Noir and Riesling wines at a long-established winemaker, such as Domaine Pfister. Dinner ashore this evening at a traditional Alsatian restaurant.

Panache / Meals: BLD

Day 4: Waltenheim-sur-Zorn to Saverne

This morning, any guests who are interested can hop on a bike and cycle to the Meteor Brewery, the last privately-owned brewery in Alsace. Otherwise, Panache cruises further along the canal, with good walking and cycling opportunities, to the enchanting town of Saverne where history traces back over 2,000 years to the Gallo-Roman Times, mooring at the foot of the Château de Rohan, also known as the 'Versailles of Alsace'. We take a walking tour of Saverne and drive up to Chateau Haut-Barr perched on the hillside and offering wonderful views. Dinner on board.

Panache / Meals: BLD

Day 5: Saverne to Lutzelbourg

This morning, perhaps after a visit to Saverne's market, we enjoy a cruise to our mooring in the pretty village of Lutzelbourg, surrounded by hills and overlooked by the ruins of the medieval castle. In the afternoon, we visit the mountaintop village of La Petite Pierre, then tour the outstanding René Lalique collection and see over 500 exceptional examples of Art Nouveau and Art Deco glassware. Nearby Wingen-sur-Moder is also the World War Two battleground where American infantry fought with distinction. Before dinner on board, time for aperitifs and perhaps some traditional Alsatian 'Flammekueche' prepared by your chef.

Panache / Meals: BLD

Day 6: Lutzelbourg to Niderviller

For early risers, there is an optional visit to a local bakery to watch skilled patissiers preparing their delicious creations, before we cruise through beautiful Alsatian countryside, visiting a fascinating local glassworks en route. We then ascend the unique Arzviller boat elevator that carries Panache 450 feet up the mountainside in minutes and enjoy a candlelit cruise through the two Arzviller tunnels to our final mooring at Niderviller. After lunch on board, we set off on a tour of Sarrebourg, including visits to the 13th century chapel containing Marc Chagall's remarkable stained-glass window and the impressive museum of Roman and Medieval artefacts. Captain's Farewell Dinner on board.

Panache / Meals: BLD

Day 7: Niderviller

After breakfast, guests are transferred by private chauffeured minibus to their choice of location in Strasbourg**.

Panache / Meals: B

This is a sample itinerary and is subject to change. On alternate weeks the cruise is in the reverse direction.

***other locations available for Private Charter bookings*

Map



Accommodation

Panache



Panache is a stylish 12 passenger hotel barge, with spacious public areas and six comfortable double or twin en suite cabins. All the bathrooms have twin handbasins and oversized showers. There are panoramic windows in the saloon and the hotel barge has been fitted out in traditional yacht style with brass and mahogany fittings. A large sun deck and spa pool, plus 12 bicycles for guests' use to explore the towpath complete the picture.

Panache's highly professional crew of six is comprised of Master Chef, Deck Hand/Steward, Tour guide and two Housekeepers, led by a knowledgeable and experienced Captain who will ensure your cruise is memorable and more. Their knowledge of the region, combined with fascinating chauffeur driven private excursions and the 12 bikes we provide will allow you to explore the areas you cruise through in as much detail as you desire.

Category: Deluxe

Cruise region: Holland - Alsace/Lorraine- Champagne

Cruise Route: Various Waterways

Pickup location: Amsterdam- Strasbourg - Paris

Departures: March - October

Length of vessel: 128 ft

Crew: 6

Max Passenger Capacity: 12

Approx Cabin Size: Jr. Suites 150 ft²

Interior Decks: 2

TV/DVD Play in Cabin Saloon: TV/DVD Player in Cabins

Air Conditioned & Centrally Heated: Yes

Demo Gallery: No

Spa Pool: Yes

Themed Cruises: Family, Golf

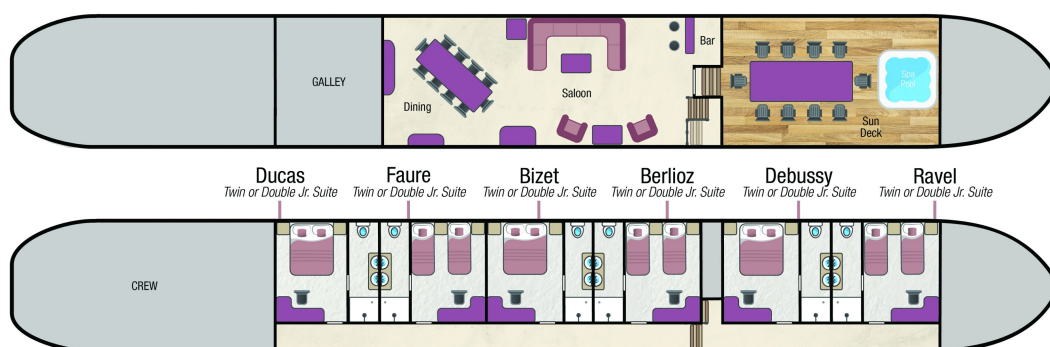

Dates & Pricing

Panache is also available for whole barge charter for 8-12 passengers, from \$100,066.

Please call A&K on 1300 851 800, send us a **booking enquiry** to book this journey or contact your travel advisor.

Abercrombie & Kent

**Call Us Now on
1300 851 924
within Australia**

Melbourne Office:

T: +61 (0)3 9536 1800

F: +61 (0) 3 9536 1805

E: contact@abercrombiekent.com.au

Address

Level 26 (North Tower)

80 Collins St

Melbourne, VIC, 3000

International:

New Zealand Call: 0800 441 638

Asia Call: 800 4747 7700