

# Abercrombie & Kent



## LA NOUVELLE ETOILE

La Nouvelle Etoile has been designed to offer a very high level of comfort and convenience, to provide an on board blend of traditional elegance and modern-day facilities.

---

European Canal Barge Cruises, Cruises



Europe, France



7 days, from AU\$12,905



Private

## Journey Overview

La Nouvelle Etoile has been designed to offer a very high level of comfort and convenience, to provide an on board blend of traditional elegance and modern-day facilities.

The spacious, air conditioned saloon with its attractive cocktail bar, piano and elegant furnishings provides a truly sophisticated setting, while other amenities include an exercise room and a lift.

Each of the four generous 200 sq ft cabin suites is lavishly equipped and the en suite bathrooms feature double hand-basins and oversized showers. On deck there is a large sun deck with comfortable loungers and a hot tub, as well as bicycles for you to pedal along the nearby towpath.

This cruise on the luxurious La Nouvelle Etoile is a journey back in time through a picturesque landscape along two delightful canals, including France's oldest, the Canal de Briare. She also cruises in Alsace, Champagne, Holland, Belgium, Picardy, Germany and Luxembourg in Spring and Autumn.

### Cruise Highlights

#### **Burgundy (*June & July*)**

Visit Château de Fontainebleau

Cross the river on the Pont Canal de Briare

Tour of Château Saint Fargeau



---

## Itinerary

### Day 1: Moret-Sur-Loing

Guests are met in Paris\*\* and transferred by private chauffeured minibus to La Nouvelle Etoile moored in the heart of the Fontainebleau forest. After a champagne welcome perhaps take a stroll through the medieval walled town of Moret-sur-Loing, known to many as the home of the famous Impressionist painter, Alfred Sisley. Tonight enjoy your first gourmet dinner on board.

***La Nouvelle Etoile | Meals: D***

### Day 2: Moret-Sur-Loing to Nemours

Today, we begin our cruise into the Upper Loire region. Affectionately known as the “Garden of Paris”, this little known region gently reveals its secrets. After lunch, we visit the Château de Fontainebleau. To walk through this palace is to walk through the history of France where each French Royal Family added its own architectural style and features when in residence. On our drive back to the barge we may visit the artist community of Barbizon. We moor for the night in Nemours. Dinner on board.

***La Nouvelle Etoile | Meals: BLD***

### Day 3: Nemours to Montargis

Today, we have a full day cruise to Montargis with plenty of opportunity to bicycle or walk along the towpath of the canal. After lunch we visit this charming town, also called “the Little Venice of the Gâtinais” because of its numerous canals. Visit one of the many museums, or shop at the famous Mazet Praline shop with its exquisitely packaged delicacies. Dinner on board.

***La Nouvelle Etoile | Meals: BLD***

### Day 4: Montargis to Châtillon Coligny

After breakfast, we set off on a leisurely cruise to the charming village of Châtillon Coligny. This afternoon, we take a drive out to the splendid 16th century Château de Saint Fargeau, which is over 1,000 years old and probably the most important place of historical interest in this unspoiled rural region, the Puisaye. Later, in the evening, there is time to stroll around the ramparts surrounding Châtillon-Coligny. Dinner on board.

***La Nouvelle Etoile | Meals: BLD***

### Day 5: Châtillon Coligny to Rogny

Today, we continue our cruise higher up the canal we reach Rogny-les-Sept-Ecluses. This “staircase” of seven locks was built in 1648 and is an impressive monument to the engineers of the past. After a relaxing lunch, we take a short drive out to the beautiful town of Gien, on the banks of the River Loire, and famous for its faïence earthenware. We also visit the International Hunting Museum at Chateau de Gien. Dinner on board.

***La Nouvelle Etoile | Meals: BLD***

**Day 6: Rogny to Briare**

After passing through the locks of Rogny, we reach the highest point of the canal and start to descend slowly towards the River Loire. At Briare, we cross the river on the Pont Canal de Briare, designed and built by Gustav Eiffel in 1890. Later, we drive to the Sancerre wine region to sample some of this delicious wine and perhaps taste some of the local Crottin de Chavignol cheese on our way back to the barge. Captain's Farewell Dinner on board.

***La Nouvelle Etoile | Meals: BLD***

**Day 7: Briare**

After breakfast, guests are transferred by private chauffeured minibus to their choice of location in Paris\*\*.

***La Nouvelle Etoile | Meals: B***

*This is a sample itinerary and is subject to change. On alternate weeks the cruise is in the reverse direction.*

*\*\*other locations available for Private Charter bookings*

## Accommodation

### La Nouvelle Etoile



La Nouvelle Etoile is an ultra deluxe barge with very spacious accommodation for only 8 passengers, offering a wonderful blend of traditional elegance and sophisticated, state of the art facilities. The elegant, air conditioned and teak-lined dining area and saloon, with an attractive bar and piano, feature warm and inviting furnishings. On deck there is a spacious sun deck with comfortable loungers and hot tub. Other facilities include internet access, exercise room and 8 bikes.

The air conditioned suites, each over 200 square feet, have satellite TV and large en-suite bathrooms with double sinks. The barge's attentive crew of five is comprised of an experienced Captain, Master Chef, Tour Guide and two Housekeepers, all of whom will ensure your cruise is truly memorable.

**Category:** Ultra Deluxe

**Cruise region:** Holland/Belgium- Belgium/Paris- Paris/Burgundy- Upper Loire/Burgundy - Champagne - Alsace/Lorraine - Luxembourg/Germany

**Cruise Route:** Various Waterways

**Pickup location:** Amsterdam- Bruges/Brussels- Paris- Frankfurt/Koblenz

**Departures:** March/July - Sept / Oct

**Length of vessel:** 129 ft

**Crew:** 5

**Max Passenger Capacity:** 8

**Approx Cabin Size:** Suites 215 ft<sup>2</sup>

**Interior Decks:** 2

**Air conditioned & Centrally Heated:** Yes

**TV/DVD Play in Cabin Saloon:** TV in Cabins, TV/DVD Player in Saloon

**Demo Gallery:** No

**Spa Pool:** Yes

**Elevator:** Yes

**Fitness Room:** Yes

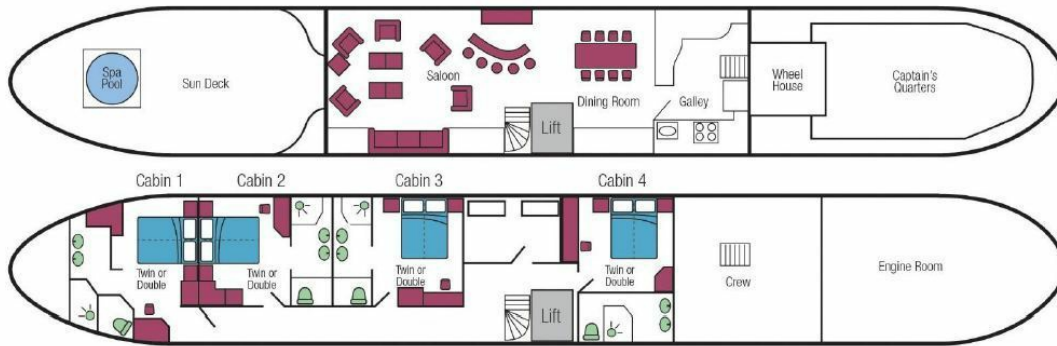

# Abercrombie & Kent

**Call Us Now on  
1300 851 924  
within Australia**

Melbourne Office:

T: +61 (0)3 9536 1800

F: +61 (0) 3 9536 1805

E: [contact@abercrombiekent.com.au](mailto:contact@abercrombiekent.com.au)

Address

Level 3, 290 Coventry St  
South Melbourne, VIC, 3205

International:

New Zealand Call: 0800 441 638

Asia Call: 800 4747 7700