

Abercrombie & Kent



ANTARCTICA, SOUTH GEORGIA & FALKLANDS EXPEDITION (2025)

Explore the colourful Falkland Islands, unspoiled South Georgia with its rookeries of king penguins, and epic Antarctica.

Cruises, A&K Luxury Expedition Cruises



Antarctica



19 days from AU\$36,915 pp



199 Guests

Journey Overview

Join this panoramic Luxury Expedition Cruise and explore the colourful Falkland Islands, unspoiled South Georgia with its rookeries of king penguins, and epic Antarctica — an ideal itinerary for photographers and explorers alike. Go ashore with your Expedition Team to visit areas rich in the history of polar exploration and experience the wildlife of the Southern Ocean region in all its glory.

Journey Highlights

- Cruise for 16 nights on an exclusively chartered voyage to Antarctica, South Georgia and the Falkland Islands
- Voyage to the Falkland Islands to explore this remote archipelago's colourful, storied history and wildlife
- Explore historic, wildlife-rich South Georgia, where you visit spectacular king penguin colonies and legendary sites that tell the tale of Antarctica's greatest explorer, Sir Ernest Shackleton
- Experience the best of Antarctica during Zodiac excursions and time onshore led by A&K's award-winning Expedition Team
- Enjoy additional photo coaching, lectures and hands-on workshops from celebrated experts in the field
- Begin your adventure with a two-night stay in Buenos Aires, exploring this fiery Latin city with your choice of shore excursion



Itinerary

Jan 5: Arrive Buenos Aires, Argentina

Upon arrival in Argentina's capital, you are met and transferred to the Palacio Duhau — Park Hyatt Buenos Aires.

Palacio Duhau / Park Hyatt Buenos Aires

Jan 6: Buenos Aires | Art of the Tango

Explore the vibrant Argentine capital of Buenos Aires with a tour and tango demonstration or delve into the city's street art scene. In the evening, gather for a welcome cocktail reception.

Palacio Duhau / Park Hyatt Buenos Aires / Meals: B

Jan 7: Ushuaia | At the Edge of the World

Fly to Ushuaia, the world's southernmost city and your gateway to Antarctica. Time permitting, you might opt for a trek in the Cerro Alarkén Nature Reserve before boarding your vessel and cruising out to sea.

'Le Lyrial' / Meals: BLD

Jan 8: The South Atlantic | Priming Your Lens

Awake to your first morning aboard. Today, cruise east toward the Falkland Islands while A&K's Expedition Team begins its lectures with a focus on photography.

'Le Lyrial' / Meals: BLD

Jan 9: The Falkland Islands | Remote Island Outpost

Today, your Captain may set a course for the remote Falkland Islands, a starkly beautiful sub-Antarctic enclave harbouring a wealth of marine and bird life. Weather permitting, take in the rugged beauty of the Falklands as you search for gentoo and rockhopper penguin colonies and the majestic albatross.

'Le Lyrial' / Meals: BLD

Jan 10: The Falkland Islands | A Closer Look

Conditions permitting, you may return to the islands to visit the historic capital of Stanley or explore its surrounding wilderness areas.

'Le Lyrial' / Meals: BLD

Jan 11: The South Atlantic | On Whale Watch

Today, your planned course continues toward South Georgia, one of the most beautiful places on earth. Whale sightings are common in this stretch of water.

'Le Lyrial' / Meals: BLD

Jan 12: The South Atlantic | The Living Sea

The open ocean is a treasure chest bursting with life. Scan the seas to spot seabirds and marine mammals as the ship cruises the nutrient-rich waters, perhaps passing the distinctive points of the Shag Rocks islets.

'Le Lyrial' / Meals: BLD

Jan 13: South Georgia | Wildlife Haven

The day's planned destination is South Georgia, one of the Southern Ocean's most biodiverse regions. Weather permitting, explore its rugged coves and shores, searching for vast colonies of king penguin.

'Le Lyrial' / Meals: BLD

Jan 14: South Georgia | Shackleton's Legacy

Today, you might learn about the exploits of Antarctic explorer Sir Ernest Shackleton as your A&K historian reveals significant whaling and exploration sites.

'Le Lyrial' / Meals: BLD

Jan 15: South Georgia | Photographer's Paradise

A photographer's paradise, beguiling South Georgia invites you to take your best shot. Conditions permitting, you may visit Gold Harbour, a vital habitat populated with fur seal, southern elephant seal and king penguin.

'Le Lyrial' / Meals: BLD

Jan 16: The Scotia Sea | Enrichment at Sea

Today's planned course plies the Scotia Sea. Prepare for your Antarctic arrival with lectures from the experts who know it best.

'Le Lyrial' / Meals: BLD

Jan 17: The Scotia Sea | Antarctic Anticipation

As Antarctica draws closer, your Expedition Team continues to build anticipation with insightful presentations. Between sessions, enjoy a drink and soak in the awe-inspiring views that surround you.

'Le Lyrial' / Meals: BLD

Jan 18: Antarctica | Incredible White Continent

Weather and ice conditions permitting, your Expedition Team takes advantage of the best opportunities for landings on the Antarctic Peninsula and the South Shetland Islands in search of gentoo and chinstrap penguin.

'Le Lyrial' / Meals: BLD

Jan 19: Antarctica | Your Team Leads the Way

Conditions permitting, get a closer look at the Antarctic Peninsula or the South Shetland Islands with more exciting shore excursions with your Expedition Team.

'Le Lyrial' / Meals: BLD

Jan 20 The Drake Passage | Wondrous Wilderness

Antarctica invites another day full of photo ops as snow-capped mountains, shimmering glaciers and iceberg-strewn channels compete for your lens.

'Le Lyrial' / Meals: BLD

Jan 21: Antarctica | A Parting Glimpse

Today, bid farewell to Antarctica as your vessel returns north toward Ushuaia. While cruising this historic passage, keep watch for the giant petrel and the elusive albatross.

'Le Lyrial' / Meals: BLD

Jan 22: The Drake Passage | Reflections at Sea

The ship's return through the Drake Passage is an interlude for recap and reflection, offering time to compare notes with your expert lecturers on the wildlife, history and geology of the White Continent.

'Le Lyrial' | Meals: BLD

Jan 23: Depart Ushuaia

After your scheduled arrival in Ushuaia, disembark and transfer for your connecting flight to Buenos Aires.

Meals: B

Journey Details:

This journey contains some active elements, including Zodiac boat excursions, walks over uneven terrain and optional, challenging hikes.

Note: Itinerary is for guidance purposes only and may be adjusted due to unforeseen circumstances including weather, wildlife, ice, medical emergencies and other conditions beyond A&K's control at the sole discretion of the Captain.

Buenos Aires/Ushuaia/Buenos Aires Economy Class flights included.

Minimum age is 7 years.

Categories 4–9 include room upgrade at the hotel and butler service aboard the ship.

First group event: excursion on Jan 6.

Last group event: disembarkation at 9:00 a.m. on Jan 23.

Included with this Luxury Expedition Cruise

- An Exclusively Chartered, All-Inclusive Voyage Led by A&K's Expedition Team
- Pre-Cruise Stay at Stylish, Ideally Located Hotel and A&K-Led Excursion
- Airport Meet and Greet and Transfers
- Private Balcony with Every Onboard Accommodation and Butler Service with Every Suite
- Maximum Personnel-to-Guest Ratio of 1 to 1.3 and ship occupancy limited to 80 percent
- Culinary Program Featuring French-Inspired Cuisine, Including House Drinks, Afternoon Tea and Pastries
- 24-Hour Room Service and Breakfast in Bed on board
- Complimentary Expedition Parka, Backpack and Water Bottle, and Use of Waterproof Pants, Boots and Trekking Poles
- Zodiac Excursions Led by A&K Expert Naturalist Driver-Guides
- Traveller's Valet Laundry Service on board
- All Gratuities, Port Charges and Taxes
- Complimentary Wi-Fi on Board and in Hotels
- Onboard Service from an English-Speaking Staff, Including an Accredited Physician
- 24/7 A&K On-Call Support

Map



Extensions



Iguazu Falls Pre-Tour Extension (2024)

[See Details](#)

Accommodation

Palacio Duhau - Park Hyatt Buenos Aires



Palacio Duhau is a superb city hotel and a member of the legendary Park Hyatt portfolio. The building itself is hugely impressive. The exterior retains the wonderful belle-époque architecture of the 1932 French Palace Duhau, whilst the interior is all sleek design and modern décor.

Its stylish, spacious rooms and exclusive suites have street or garden views and are immaculately presented, with modern décor offering a backdrop for the latest technology and luxurious furnishings. All have plush king sized beds, oversized work desks and majestic bathrooms with tub and rain shower. Luxurious touches include Celedonio Lohido-designed spa products, 30-inch flat-screen TVs and butler service.

Why we like it

- The rooms and suites are spacious and packed with luxurious touches
- Palacio Duhau is in an ideal central location on Avenida Alvear
- Dining options include the signature Duhau Restaurant and, for something special, the Vinoteca & Cheese Room, which offers fine Argentinian Malbecs and regional cheeses selected by the Maître Fromager
- The Ahin Spa can only be described as 'sumptuous'
- A beautiful, short-course indoor heated swimming pool is located in the spa

Le Lyrial



An A&K voyage to Antarctica offers the opportunity to experience the world's most pristine region at its very best on board the comfortable and sophisticated Le Lyrial. Enjoy its stunning blue palette inspired by the Vega star, all-balcony staterooms and suites, and the finest expedition staff cruising the southern ocean today.

On other cruises to different destinations, she carries more than 264 passengers: on voyages with A&K, we limit her capacity to just 199 clients. Fewer passengers in turn allows for more shore excursions each day and cabins with private balconies for every guest.

Relax in the on-board spa and hammam or take a dip in the outdoor heated saltwater pool with panoramic ocean views to the horizon.

The two on-board restaurants offer a selection of gourmet and international cuisine while the airy and elegant communal areas provide the perfect mix of quiet corners and sociable spaces. By day, enjoy a series of enriching lectures by leading experts about your natural surroundings. Then by night, the Club Lounge and the Theatre take care of your evening's entertainment with a variety of live music shows and film screenings.

Amenities

- All outside staterooms and suites offer a private balcony when chartered by A&K
- Complimentary butler service for Deck 6, categories 4-9
- Sun deck and multiple outer deck observation areas
- Outside heated saltwater pool
- Library with extensive selection of books and reading areas
- Panoramic lounge and terrace

- Three bars and a boutique
- Fitness centre with state-of-the-art equipment
- Hairdresser offering full-service hair styling, manicures and pedicures
- Spa and hammam (steam room)
- On-board medical facilities with certified doctor
- 24-hour room service and laundry services
- The Club lounge hosts live music and dancing
- The Theatre offers unobstructed-view seating for live performances and film screenings
- Wireless internet access throughout the ship
- Dynamic positioning system

Strength and Style

- Sophisticated design, innovative marine technology and a convenient layout aided by three passenger elevators are among 'Le Lyrial's' many features.
- On A&K voyages, we limit her capacity to just 199 guests, allowing for more shore excursions each day and cabins with private balconies for every guest.

Safety

- Safety is first and foremost on board sturdy 'Le Lyrial.'
- The ship features the latest communication, navigational and safety equipment.
- A&K's English-speaking staff is readily available to assist and instruct on safety at all times during your cruise.

Environmentally Sound Operations

- In keeping with A&K's longstanding commitment to environmental conservation, 'Le Lyrial' is equipped with the most eco-friendly technology available today.
- Our expeditions exceed all environmental protocols, including those set by the National Science Foundation, Environmental Protection Agency and Antarctic Treaty Party nations.

Rest and Relaxation Redefined

- Among the most comfortable available on any polar expedition ship, all 108 cabins are fully equipped and feature bedding configurations that range from king-size beds to two single beds.
- Premier and Privilege Two-Room Suites feature a sofa that converts to a fixed queen-size bed, and the option to convert into a two-room cabin - perfect for families. 'Le Lyrial' also offers an additional Grand Deluxe Suite.
- 'Le Lyrial' is outfitted with a technologically advanced stabilizing system to minimize the effects of rough conditions and help keep passengers comfortable at all times.

Space to Meet and Mingle

- Spacious and elegant, 'Le Lyrial's' common areas invite casual conversation with fellow

guests as well as private reflection and views in quiet corners.

- The Panoramic Lounge and Terrace offer spacious areas ideal for social gatherings, afternoon tea or just relaxing with ocean views.
- The Club offers an elegant atmosphere in the evening, with live music and dancing, while the Theatre is the ideal venue for nightly entertainment, enrichment lectures and movies.

International Cuisine

- The Restaurant offers gourmet and international cuisine while The Compass Grill delivers casual indoor and outdoor dining for breakfast, lunch and themed dinners.
- There is always a selection of light fare and vegetarian dishes, and most special diets can be accommodated with advance notice.
- In-cabin room service is available 24/7.

Personal Butler Service on Board

- Cabin Categories 4-9 on Deck 6 receive the complimentary services of a private butler.
- From ensuring your suite is up to your standards to organizing cocktails on your private balcony, your butler tends to your every need, with grace and efficiency.

'Le Lyrial'

Category 1
Classic Stateroom

Category 2
Deluxe Stateroom

Category 3
Premier Stateroom

Category 4*
Prestige Suite

Category 5*
Premier Two-Room Suite

Category 6*
Privilege Two-Room Suite

Category 7*
Grand Deluxe
Two-Room Suite

Category 8*
Grand Privilege
Three-Room Suite

Category 9*
Owner's Suite

*Butler Service Included

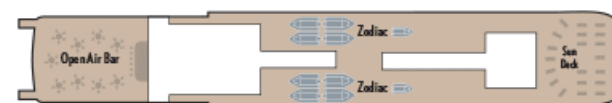

DECK 7

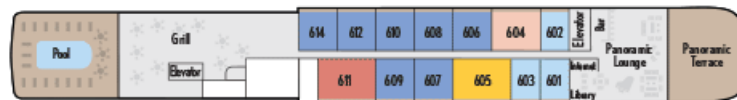

DECK 6

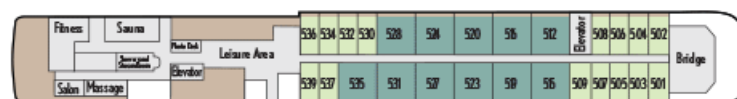

DECK 5

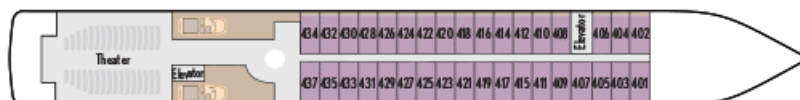

DECK 4

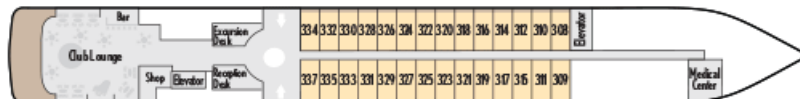

DECK 3



DECK 2

BUTLER SERVICE INCLUDED





Categories 1-3
Staterooms
Cabin: 18 sq. mt. | Balcony: 4 sq. mt.



Category 4
Prestige Suite
Cabin: 27 sq. mt. | Balcony: 6 sq. mt.

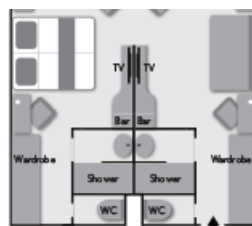

Category 5
Premier Two-Room Suite
Cabin: 36 sq. mt. | Balcony: 8 sq. mt.

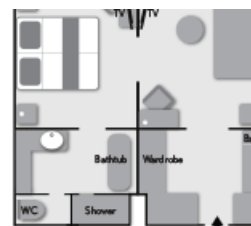

Category 6
Privilege Two-Room Suite
Cabin: 36 sq. mt. | Balcony: 8 sq. mt.

BUTLER SERVICE INCLUDED

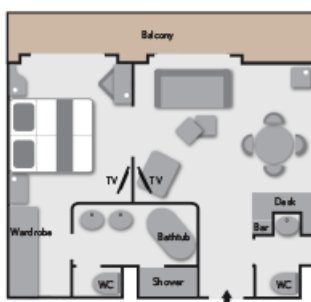

Category 7
Grand Deluxe Two-Room Suite
Cabin: 45 sq. mt. | Balcony: 10 sq. mt.

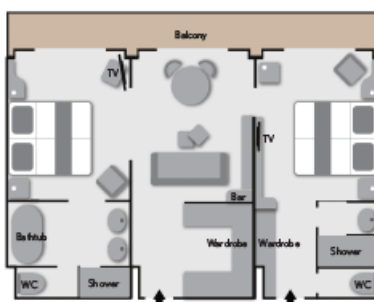

Category 8
Grand Privilege Three-Room Suite
Cabin: 54 sq. mt. | Balcony: 12 sq. mt.

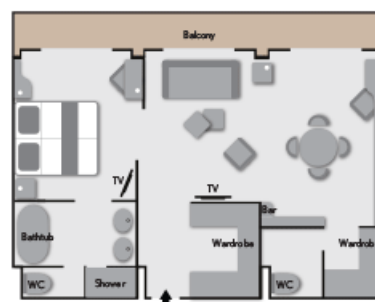

Category 9
Owner's Suite
Cabin: 54 sq. mt. | Balcony: 12 sq. mt.

Dates & Pricing

Prices are in AUD, per person, based on double occupancy

Jan 5, 2025 - Jan 23, 2025

Cabin Class	Price	Single Supplement	Internal Air (From)	Availability
Le Lyrial: Classic Balcony Stateroom - Category 1	AU\$45,370 NOW ONLY AU\$36,915 pp	AU\$32,885	Included	Call for Availability
Cabin Class	Price	Single Supplement	Internal Air (From)	Availability
Le Lyrial: Deluxe Balcony Stateroom - Category 2	AU\$49,985 NOW ONLY AU\$41,530 pp	AU\$36,345	Included	Call for Availability
Cabin Class	Price	Single Supplement	Internal Air (From)	Availability
Le Lyrial: Premier Balcony Stateroom - Category 3	AU\$53,060 NOW ONLY AU\$44,605 pp	AU\$38,655	Included	Call for Availability
Cabin Class	Price	Single Supplement	Internal Air (From)	Availability
Le Lyrial: Prestige Balcony Suite - Category 4	AU\$72,290 NOW ONLY AU\$63,835 pp	AU\$61,375	Included	Call for Availability
Cabin Class	Price	Single Supplement	Internal Air (From)	Availability
Le Lyrial: Premier Two-Room Balcony Suite - Category 5	AU\$84,600 NOW ONLY AU\$76,145 pp	AU\$73,070	Included	Call for Availability
Cabin Class	Price	Single Supplement	Internal Air (From)	Availability
Le Lyrial: Privilege Two-Room Balcony Suite - Category 6	AU\$89,985 NOW ONLY AU\$81,530 pp	AU\$78,190	Included	Call for Availability
Cabin Class	Price	Single Supplement	Internal Air (From)	Availability
Le Lyrial: Grand Deluxe Two-Room Balcony Suite - Category 7	AU\$96,140 NOW ONLY AU\$87,685 pp	AU\$84,040	Included	Limited Availability
Cabin Class	Price	Single Supplement	Internal Air (From)	Availability
Le Lyrial: Grand Privilege Three-Room Balcony Suite - Category 8	AU\$109,215 NOW ONLY AU\$100,760 pp	AU\$96,455	Included	Limited Availability
Cabin Class	Price	Single Supplement	Internal Air (From)	Availability
Le Lyrial: Owner's Balcony Suite - Category 9	AU\$113,060 NOW ONLY AU\$104,605 pp	AU\$100,115	Included	Limited Availability

Abercrombie & Kent

**Call Us Now on
1300 851 924
within Australia**

Melbourne Office:

T: +61 (0)3 9536 1800

F: +61 (0) 3 9536 1805

E: contact@abercrombiekent.com.au

Address

Level 26 (North Tower)

80 Collins St

Melbourne, VIC, 3000

International:

New Zealand Call: 0800 441 638

Asia Call: 800 4747 7700