

Abercrombie & Kent



MAGNA CARTA RIVER CRUISE

Lovely 'Magna Carta' takes you on a voyage of discovery on the River Thames. Explore the tapestry of English history with visits to 11th-century Windsor Castle and Dorney Court, a Tudor manor house, and the lush gardens of 17th-century Cliveden — home of the Astors.

Cruises, European Canal Barge Cruises



Europe, England



7 days from AU\$9,035 pp



Private

Journey Overview

Lovely 'Magna Carta' takes you on a voyage of discovery on the River Thames. Explore the tapestry of English history with visits to 11th-century Windsor Castle and Dorney Court, a Tudor manor house, and the lush gardens of 17th-century Cliveden — home of the Astors. Later, meet master craftspeople at work in a boatyard.

Cruise Highlights

- Explore Henry VIII's Hampton Court Palace
- Moor beneath and visit Windsor Castle
- Moor at the Cliveden estate and tour its gardens
- Tour the Stanley Spencer Gallery at Cookham
- Great walking and bicycling opportunities along the Thames Footpath
- Tour of Highclere Castle (Downton Abbey) on selected departures
- English cream tea at the Stafford Hotel, London



Itinerary

Day 1: Sunday

Meet in London for a traditional English cream tea before transferring to 'Magna Carta,' moored at Hampton Court. After a reception and captain's welcome, sit down to a gourmet dinner on board.

'Magna Carta' | Meals: D

Day 2: Monday

Visit Hampton Court Palace, built by Cardinal Wolsey in the early 16th century. Wander through the 60 acres of beautiful riverside gardens with their famous maze before an afternoon cruise to Bell Weir Lock at Runnymede.

'Magna Carta' | Meals: BLD

Day 3: Tuesday

'Magna Carta' cruises past its namesake memorial this morning where the first Bill of Rights was signed in 1215. In the afternoon, visit Windsor Castle. Built in the 11th century by William the Conqueror, it is still inhabited by the modern-day Royal Family.

'Magna Carta' | Meals: BLD

Day 4: Wednesday

Cruise to Boveney Lock for a private tour of Dorney Court, which has been owned by the Palmer Family for 450 years. It has provided a lovely setting for films such as Poirot and The Other Boleyn Girl. Then cruise to an exclusive mooring on the celebrated estate of Cliveden.

'Magna Carta' | Meals: BLD

Day 5: Thursday

At Cookham, visit the Stanley Spencer Gallery with time to walk in the village he loved and frequently painted. Continue to Hurley-on-Thames to observe traditional craftspeople working at Peter Freebody's boatyard, a fixture on the Thames for more than 300 years.

'Magna Carta' | Meals: BLD

Day 6: Friday

Take a drive to Oxford, one of England's oldest university towns. Tour Christ Church, Oxford's grandest college, before returning to 'Magna Carta' for a gala farewell dinner to end the memorable week.

'Magna Carta' / Meals: BLD

Day 7: Saturday

After breakfast, disembark at Henley-on-Thames and transfer back to London where your journey ends.

Meals: B

Route runs in reverse on alternate weeks and may differ on selected cruise dates.

Inclusions

- Canal Barges Hand-Selected by A&K
- Choice of Individual Travel or Private Charters Available
- Transfers to/from Barges
- All Meals and Drinks on Board
- All Sightseeing Excursions During the Cruise
- 24/7 A&K On-Call Support

Map

□

Accommodation

Magna Carta



Magna Carta is one of the finest, most luxurious vessels cruising the British Isles today. The ambience created by combining a traditional 1936-built barge hull with fine mahogany, teak and oak is outstanding. Modern amenities include under floor heating, spa pool and contemporary en suite facilities for the four spacious 18.5 square metre suites. The upper deck saloon and dining area feature picture windows and stylish furnishings. A Master Chef produces a range of mouth-watering dishes whilst you enjoy the sights of royal Berkshire, historic Buckinghamshire and beautiful Oxfordshire from your floating country inn. The barge's experienced Captain knows the Thames well and will pilot the barge and be your tour guide. Two house keepers complete the crew of four.

Category: Deluxe

Cruise region: England

Cruise Route: River Thames

Pickup location: London

Departures: March - October

Length of vessel: 117 ft

Crew: 4

Max Passenger Capacity: 8

Approx Cabin Size: Suites 200 ft²

Interior Decks: 2

Air Conditioned / Centrally Heated: Yes

TV/DVD Play in Cabin Saloon: TV/DVD Player in Cabins

Demo Gallery: No

Spa Pool: Yes

Theme Cruises: Royal, Antiques, Family, Chelsea Flower Show, Hampton Court Flower Show

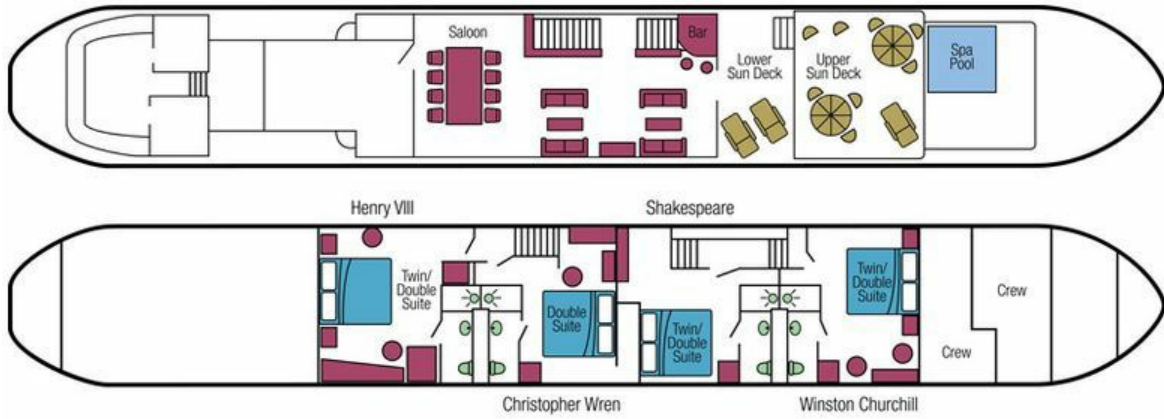

Abercrombie & Kent

**Call Us Now on
1300 851 924
within Australia**

Melbourne Office:

T: +61 (0)3 9536 1800

F: +61 (0) 3 9536 1805

E: contact@abercrombiekent.com.au

Address

Level 26 (North Tower)

80 Collins St

Melbourne, VIC, 3000

International:

New Zealand Call: 0800 441 638

Asia Call: 800 4747 7700