



## SHANNON PRINCESS RIVER CRUISE

The River Shannon and its lakes represent Ireland at its finest and your cruise aboard Shannon Princess features a landscape of rolling green fields, ancient Celtic landmarks and an abundance of wildlife.

---

European Canal Barge Cruises, Cruises



Europe, Ireland



7 days from AU\$7,918 pp



Private

## Journey Overview

The River Shannon and its lakes represent Ireland at its finest and your cruise aboard Shannon Princess features a landscape of rolling green fields, ancient Celtic landmarks and an abundance of wildlife.

The legends and fables of Ireland are found everywhere and are well understood by the hospitable Irish people who will be happy to tell you more about the ancient culture. The history of Ireland has been varied and sometimes difficult, but the locals always find the time to chat and perhaps charm you a tale or two of folklore.

During your cruise, there is a programme of fascinating excursions that will give you a true immersion into the heritage and traditions of this part of Ireland, such as a personal tour of a castle by its eccentric owner, a birds of prey display, visits to a whiskey distillery and hand-weaving workshop and, of course, the chance to sample a pint or two of the 'black stuff' – Guinness.

Shannon Princess, accommodating 10 guests in comfort, is the largest hotel barge to be cruising the River Shannon and its picturesque, intertwining lakes. Her thoughtfully-designed interior includes a comfortable saloon and dining area with panoramic windows. The five junior twin/double cabin suites, also with picture windows, are stylishly furnished and each is air-conditioned, centrally heated, and accompanied by a modern en-suite shower room.

The large rooftop sundeck is certainly the place to relax, perhaps on one of the comfortable loungers, to watch the countryside glide slowly by, or in the heated spa pool. There is also an inviting dining area with circular table to savour that gourmet meal on warmer days.

Shannon Princess's Captain and his crew will go out of their way to ensure your every need is accommodated, while your Master Chef who was trained at the Ballmaloe School, will create some wonderful signature dishes to make your enthralling voyage through the 'Emerald Isle' complete.

### Cruise Highlights

- Tour the legendary 6thC Clonmacnoise ruins
- Full day excursion to Portumna Castle and Galway
- Traditional Guinness and oyster lunch
- Visit the unusual haunted Leap Castle
- Tour Birr Castle's Gardens and Science Centre

- Birds of prey demonstration at Adare Manor
- Tour of the Kilbeggan Whiskey Distillery with a private tasting
- Visit a traditional Irish hand-weaving workshop
- Hear traditional Irish music
- Excellent walking and fishing opportunities



## Itinerary

### Day 1: Glasson

Guests are met in Dublin\*\* and transferred by private chauffeured minibus to Shannon Princess. Your Captain and his crew welcome you on board with champagne, Black Velvets or Irish coffees. Time perhaps for a gentle stroll before your first dinner on board.

***Shannon Princess / Meals: D***

### Day 2: Glasson to Athlone

This morning we begin our cruise around the beautiful “Inner Lakes” of Lough Ree and then continue north as we explore some of the 365 islands on the lake. We then circle back to the River Shannon and onto our mooring in Athlone Town. After lunch we visit the Kilbeggan Whiskey Distillery, dating from 1757 and the oldest licensed whiskey distillery in the world. On the return journey there is time for a visit to Ballinahown, an artisan craft village. Dinner on board.

***Shannon Princess / Meals: BLD***

### Day 3: Athlone to Shannonbridge

Today we negotiate Athlone Lock and head south through Europe’s richest example of “Callow” landscape. We moor at Clonmacnoise ruins, a famed 6th century university and an early monastic settlement. Following a tour, we cruise on to our mooring at Shannonbridge. Then, after lunch we visit Leap Castle, reputed to be Ireland’s most haunted house. You will be given a personal tour by the eccentric owner Sean Ryan, whom with traditional Irish musicians, will relate to you the fascinating history of the castle and its part in founding the American Constitution. After dinner on board, perhaps join the captain for a pint in Killeen’s pub and an evening with the locals.

***Shannon Princess / Meals: BLD***

### Day 4: Shannonbridge to Terryglass

This morning, we cruise a very pretty stretch of the River Shannon through Meelick lock, pausing as Portumna swing bridge is opened to allow us passage onto idyllic Lough Derg and then moor at Terryglass Harbour. This afternoon we visit Birr Castle, still resided in by the Earl of Rosse and family, to see the magnificent gardens, the fascinating Science Centre and admire the historic Great Telescope. Dinner on board.

***Shannon Princess / Meals: BLD***

---

### Day 5: Terryglass to Mountshannon

Today, our tour is firstly, to the walled gardens of Portumna Castle, then on to Galway, a lively University City and cultural centre for Irish-speaking regions in Western Ireland. Visit the Galway crystal, craft and linen shops and then lunch at a traditional Guinness & Oyster pub. We return to Shannon Princess and set sail across beautiful Lough Derg, passing Forrest Park and ancient mountains as we enjoy our dinner and sunset cruise to Mountshannon – a lovely lakeside village perched above the Lough.

***Shannon Princess / Meals: BLD***

### Day 6: Mountshannon to Killaloe

Today we set sail across south Lough Derg, re-joining the River Shannon to moor at Killaloe, once home to the court of the greatest High King of Ireland, Brian Boru. After exploring this elegant little town, we lunch on board, then set off to Adare Manor, a magnificent estate located on the banks of the River Maigue. Here, in the setting of the Walled Garden, we gain a real insight into the history and tradition of falconry and have the opportunity to ‘get up close and personal’ with birds of prey such as owls, falcons and eagles – a magical experience. We end the afternoon by visiting a traditional Irish hand-weaving workshop. ‘Sláinte’ cocktail reception and Captain’s Farewell Dinner on board.

***Shannon Princess / Meals: BLD***

### Day 7: Killaloe

After breakfast, guests are transferred by private chauffeured minibus to Dublin\*\*.

***Meals: B***

*This is a sample itinerary and is subject to change. On alternate weeks the cruise is in the reverse direction.*

*\*\*other locations available for private Charter bookings*

### Inclusions

- Comfortable accommodation in air-conditioned, en suite staterooms or suites
- Gourmet meals prepared by the on-board chef, fine wines and an open bar
- Daily escorted excursions to places of interest and private wine tastings
- Local transfers, for example to and from Dublin
- Bicycles and on most hotel barges, an on-deck spa pool
- Attentive service from an experienced crew – Captain, chef, tour guide and hosts/hostesses

## Map





## Accommodation

### Shannon Princess



The ten passenger Shannon Princess is the largest hotel barge cruising the River Shannon. Her thoughtfully designed interior includes five twin/double bedded suites with Loughside views, a comfortable saloon/dining area and a full-length upper sun deck with spa pool. The five suites have en suite facilities and give a choice of twin or double bed configuration. Her experienced Captain and crew go out of their way to ensure your every need is accommodated. Your Master Chef was trained at the Ballymaloe School and distinguishes herself with the creation of some wonderful signature dishes.

**Category:** Deluxe

**Cruise region:** Ireland

**Cruise Route:** River Shannon & Its Loughs

**Pickup location:** Dublin

**Departures:** April - September

**Length of vessel:** 107 ft

**Crew:** 5

**Max Passenger Capacity:** 10

**Approx Cabin Size:** Staterooms 125

**Interior Decks:** 1

**TV/DVD Play in Cabin Saloon:** -

**Demo Gallery:** No

**Spa Pool:** Yes

**Themed Cruises:** Family, Walking, Golf, Artisan

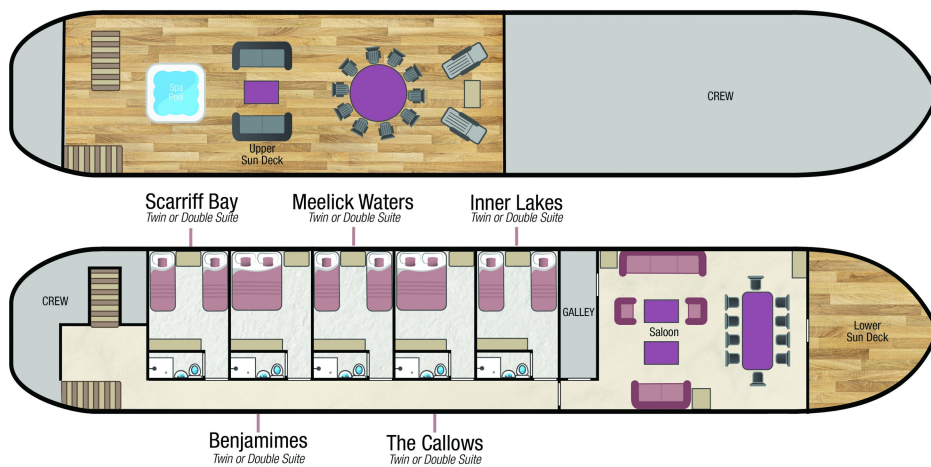



## Dates & Pricing

Shannon Princess is also available for whole barge charter for 6-10 passengers, from \$65,783.

Please call A&K on 1300 851 800, send us a **booking enquiry** to book this journey or contact your travel advisor.

# Abercrombie & Kent

**Call Us Now on  
1300 851 924  
within Australia**

## Melbourne Office:

T: +61 (0)3 9536 1800

F: +61 (0) 3 9536 1805

E: [contact@abercrombiekent.com.au](mailto:contact@abercrombiekent.com.au)

## Address

Level 26 (North Tower)

80 Collins St

Melbourne, VIC, 3000

## International:

New Zealand Call: 0800 441 638

Asia Call: 800 4747 7700